

# RM-MS Multistage, magnetically coupled centrifugal pump

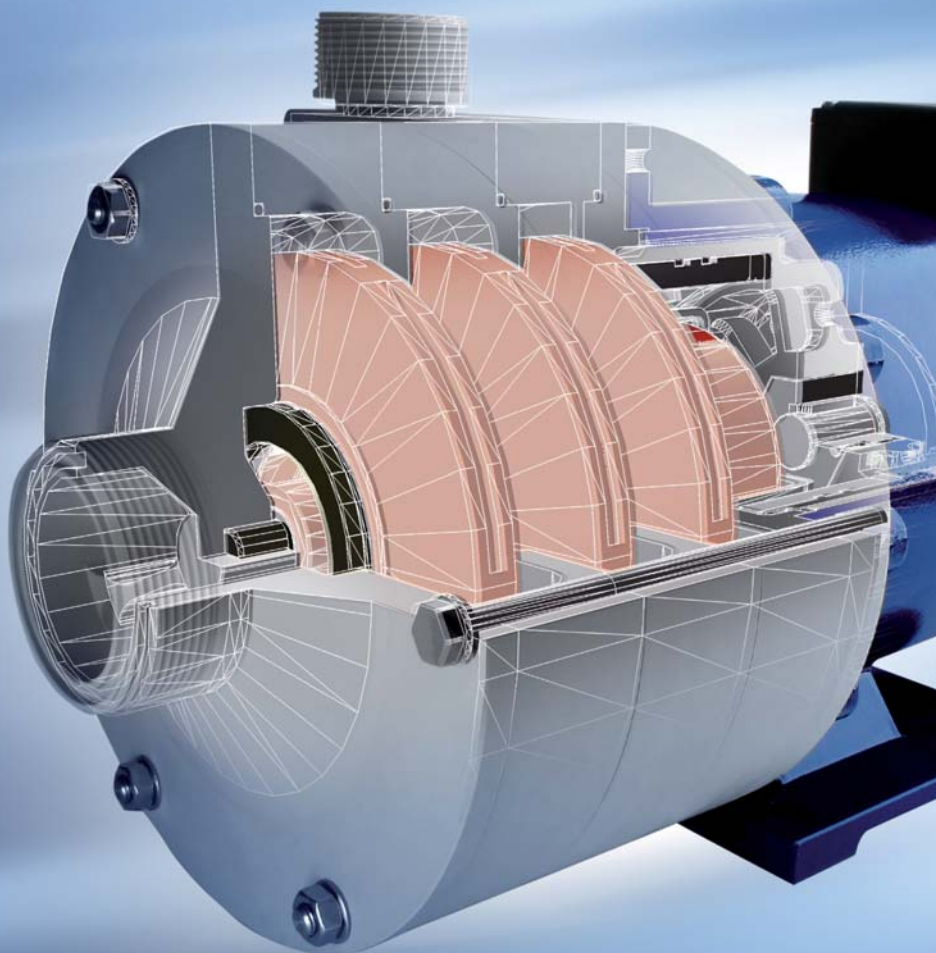

RM-MS, efficient  
pumping of chemicals  
with high pressure.

1959-2009  
**50**  
**YEARS**  
SONDERMANN  
PUMPS + FILTERS



**SONDERMANN**  
PUMPEN + FILTER GMBH & Co. KG

Competence in pump  
and filter technologies

# Increased efficiency in high pressure applications with multistage, magnetically coupled pump RM-MS.

## The advantages of type RM-MS at a glance:

- ▶ Energy efficient in high pressure operation
- ▶ Flexible and modular design
- ▶ Multistage with 1, 2, or 3 impeller
- ▶ Driven by magnetic coupling
- ▶ Best hydraulic efficiency
- ▶ Environment friendly by hermetically sealed pump housing
- ▶ Best chemical resistance
- ▶ Metal-free design made of PP or PVDF

### Performance charts type RM-MS

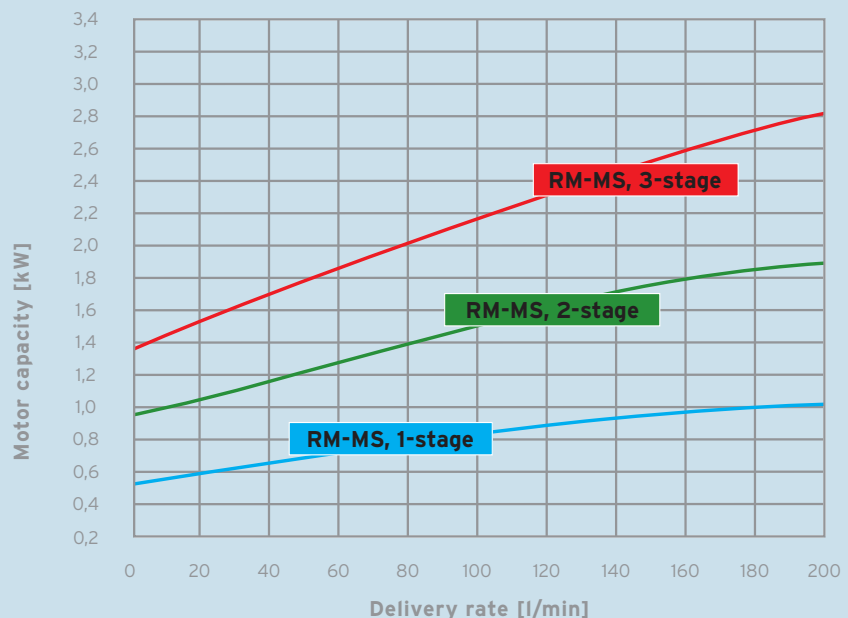
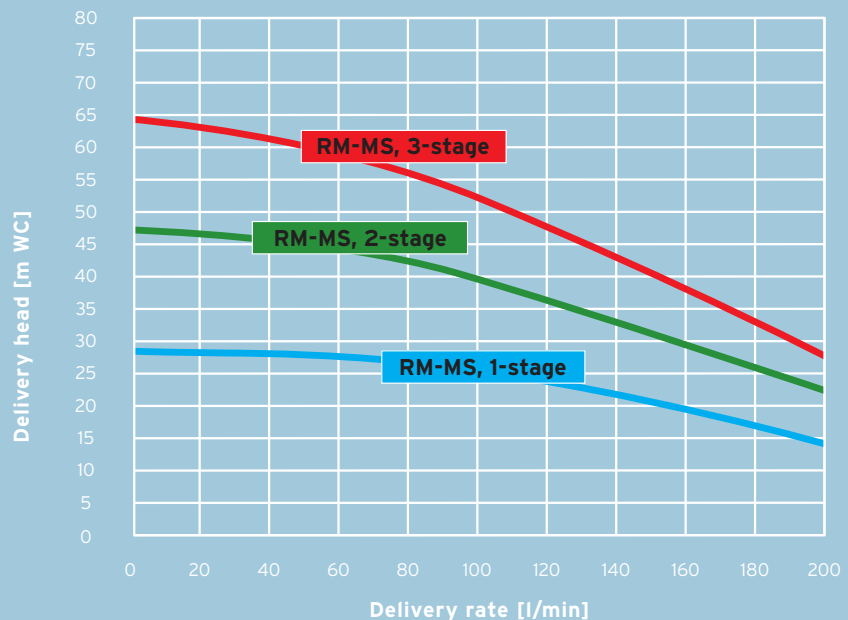

In high pressure applications singlestage centrifugal pumps are not very efficient. For operation in high pressure ranges multistage centrifugal pumps are required. That is to say, multiple centrifugal pumps respectively impellers are connected in series. In series connection the delivery heights will add together. In high pressure ranges the type RM-MS will reach a higher efficiency than a singlestage centrifugal pump for higher delivery rates, which works in unfavourable operational area.





# NEW!

## Technical data

size	RM-MS, 1-stage	RM-MS, 2-stage	RM-MS, 3-stage
maximum delivery rate [l/min]	200	200	200
maximum delivery head [m WC]	28	47	65
motor capacity [kW]	0,75 - 3,0		
voltage at 50 Hz [V]	220 - 240 / 380 - 415		
voltage at 60 Hz [V]	255 - 277 / 440 - 480		
protection class	IP 55		
connections	suction side G 2 1/4	pressure side G 1 1/2	
materials	PP	PVDF	
max. temperature [° C]	80	90	
max. system pressure at 20° C [bar]	8,0	8,0	

## Types and sizes

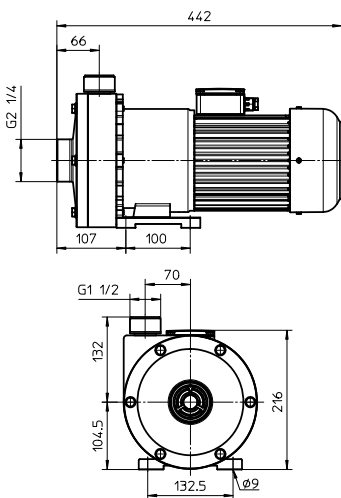

**RM-MS, 1-stage**  
1,5 kW

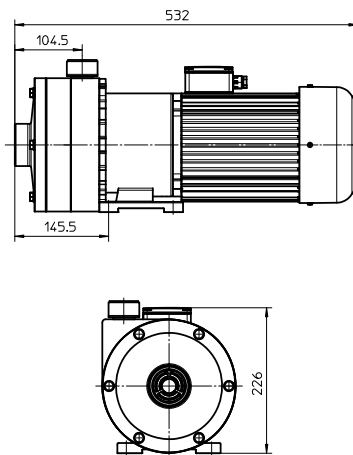

**RM-MS, 2-stage**  
2,2 kW

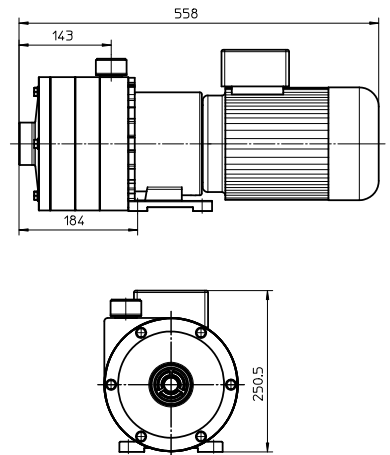

**RM-MS, 3-stage**  
3,0 kW

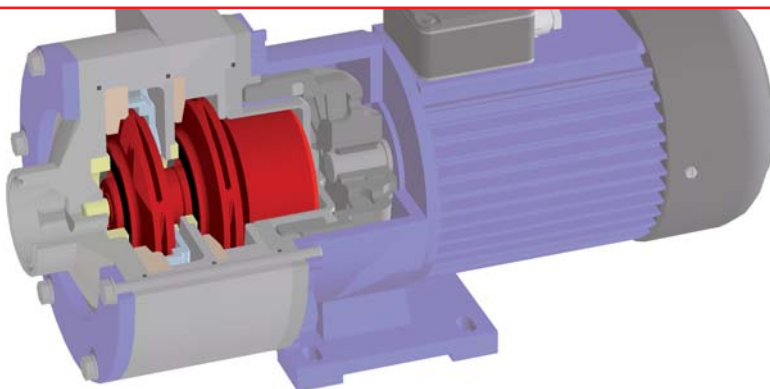

Competence in pump and filter technology. This means excellent product quality, reliable service and long-standing experience. And this since 50 years.



**SONDERMANN**  
PUMPEN + FILTER GMBH & Co. KG

# Sondermann's RPR Control-100 for electronic process monitoring of pumps.

1959-2009  
**50**  
**YEARS**  
SONDERMANN  
PUMPS + FILTERS



**Separate programming unit**  
Hand-held programmer with  
cable and plug to programme  
specific switching thresholds  
to RPR Control-100 1 and  
100 3 systems

Users of centrifugal pumps are only too well aware of the problem that most pumps do not fail because of progressive wear but, long before their end of life, due to critical operating conditions like dry running, overheating or operation in cavitation.

The active-power meter integrated to the RPR Control-100 system has 4 user-programmable switching thresholds assigned to the following operating conditions:

- ▶ Dry running
- ▶ Overheating
- ▶ Overload
- ▶ Flow rate falling below minimum value



**RPR Control-100 1**  
to be built into control  
cabinets and plug in the  
separate programming unit  
(mounted on top-hat rail)



**Portable RPR Control-100 3**  
with indicating lamps  
and push-buttons but  
without programming  
unit



**RPR Control-100 2**  
to be built into control  
cabinets with integrated  
programming unit  
(mounted on top-hat rail)

Our product specialists will be glad to help you. Please  
take contact to your personal adviser - by phone or eMail:

 **+49.2203.9394-0**

rm-ms@sondermann-pumpen.de



**SONDERMANN**  
PUMPEN + FILTER GMBH & Co. KG

Sondermann Pumpen + Filter  
GmbH & Co. KG

August-Horch-Straße 4, D-51149 Cologne

Tel. +49.2203.9394-0

Fax +49.2203.9394-48

info@sondermann-pumpen.de

www.sondermann-pumpen.de